

## DS-2CD2520F 2MP Mini Dome Network Camera



### Key features

- Up to 2 megapixel (1920 x 1080) resolution
- HD1080p real-time video
- DWDR & BLC
- 3D DNR
- Support on-board storage (up to 64GB)
- IP66
- Vandal-proof

### Dimensions

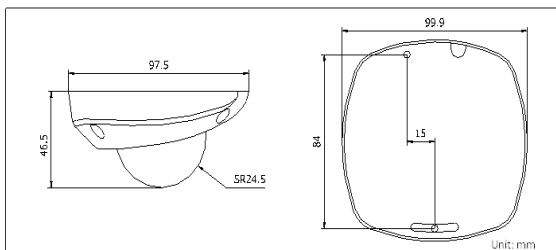

### Accessories



DS-1271ZJ-120  
Pendant mount



DS-1272ZJ-120  
Wall mount

DS-2CD2520F	
<b>Camera</b>	
Image sensor	1/2.8" progressive scan CMOS
Min. illumination	Color: 0.01 lux@F1.2, AGC On; 0.028lux@F2.0, AGC On B/W: 0.001 lux@F1.2, AGC On; 0.0028lux@F2.0, AGC On
Shutter time	1/3s ~ 1/100,000s
Lens	4mm@F2.0, angle of view: 79° (4mm) (2.8mm, 6mm optional)
Lens mount	M12
Day & night	Electronic
Adjustment angle	Pan: ±15°, tilt: 0~90°, rotation: ±15°
Digital noise reduction	3D DNR
Wide dynamic range	Digital WDR
Backlight compensation	Yes, zone configurable
<b>Compression standard</b>	
Video compression	H.264 / MJPEG
H.264 compression profile	Baseline/ Main profile
Bit rate	32 Kbps ~ 8 Mbps
<b>Image</b>	
Max. image resolution	1920 x 1080
Frame rate	50Hz: 25fps (1920 x 1080), 25fps (1280 x 960), 25fps (1280 x 720) 60Hz: 30fps (1920 x 1080), 30fps (1280 x 960), 30fps (1280 x 720)
Image settings	Rotate mode, saturation, brightness, contrast adjustable through client software or web browser
<b>Network</b>	
Network storage	NAS
Alarm trigger	Motion detection, tampering alarm, network disconnect, IP address conflict, storage exception, storage error, intrusion detection, line crossing detection
Protocols	TCP/IP, ICMP, HTTP, HTTPS, FTP, DHCP, DNS, DDNS, RTP, RTSP, RTCP, PPPoE, NTP, UPnP, SMTP, SNMP, IGMP, 802.1X, QoS, IPv6, Bonjour
System compatibility	ONVIF, PSIA, CGI, ISAPI
General functionalities	Flickerless, dual stream, heartbeat, mirror, user authentication, video mask, watermark
<b>Interface</b>	
Communication interface	1 RJ45 10M / 100M ethernet port
On-board storage	Built-in Micro SD/SDHC/SDXC card slot, up to 64 GB
<b>General</b>	
Operating conditions	-30 °C ~ 60 °C (-22 °F ~ 140 °F), humidity 95% or less (non-condensing)
Power supply	DC12V ± 10%, PoE (802.3af)
Power consumption	Max. 4W
Ingress protection level	IP66
Impact protection	IEC60068-2-75Eh, 20J; EN50102, up to IK10
Dimensions (mm)	99.9 x 97.5 x 46.5
Weight	400g

### Available models

DS-2CD2520F